

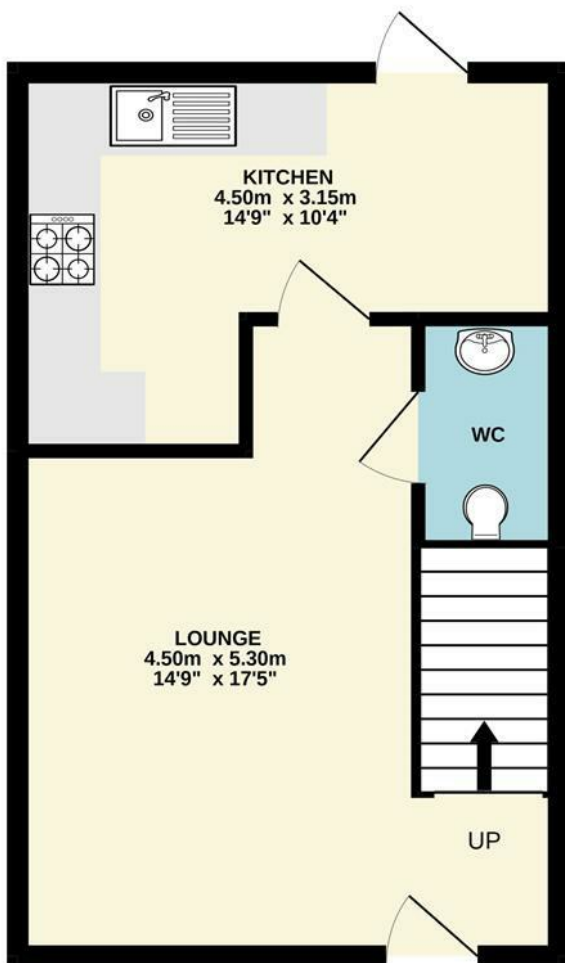

Bittern Avenue | Norwich | NR7  
 Fixed Asking Price £174,667

abbotFox

GROUND FLOOR  
 33.1 sq.m. (356 sq.ft.) approx.



1ST FLOOR  
 30.3 sq.m. (326 sq.ft.) approx.

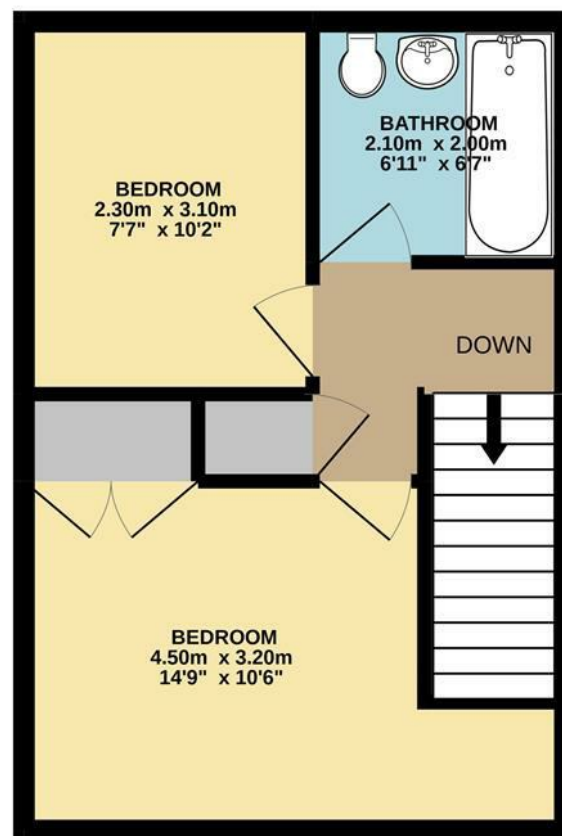

TOTAL FLOOR AREA: 63.4 sq.m. (682 sq.ft.) approx.

Whilst every attempt has been made to ensure the accuracy of the floorplan contained here, measurements of doors, windows, rooms and any other items are approximate and no responsibility is taken for any error, omission or mis-statement. This plan is for illustrative purposes only and should be used as such by any prospective purchaser. The services, systems and appliances shown have not been tested and no guarantee as to their operability or efficiency can be given.  
 Made with Metropix ©2021

Energy Efficiency Rating		Current	Potential
Very energy efficient - lower running costs			97
(92 plus) A			
(81-91) B		84	
(69-80) C			
(55-68) D			
(39-54) E			
(21-38) F			
(1-20) G			
Not energy efficient - higher running costs			
England & Wales		EU Directive 2002/91/EC	

Disclaimer – In accordance with the Property Misdescriptions Act, the company gives notice that all descriptions, references to condition, necessary permissions for use and other details are given in good faith and believed to be correct, but any intending lessees do not rely on them as statements of fact, but must satisfy themselves by inspection or other means, as to their accuracy.



abbotFox presents this affordable home, located within the popular residential area of Sprowston. An ideal opportunity for any first time buyer, this stylish two bedroom home has been exceptionally well maintained by the current owners since its construction., With accommodation comprising of two double bedrooms and a family bathroom to the first floor, the ground floor offers a spacious lounge diner and kitchen breakfast room. With the property occupying a prime position overlooking a green to the front, and providing a private enclosed rear garden, this home also offers allocated parking to the rear. An internal viewing comes highly recommended for this home.

**Estate agents note:**

This home is offered to the market at an 80% discounted rate, please note no rent is payable upon the remaining 20%. Any interested parties will be required to register with Help To Buy South with eligibility requirements needing to be met. For further information, please contact the sales team.

